

EASEMENTS

- (DC) Easement for sewer gravity main - variable width (Stage 4)
- (DJ) Easement for multipurpose electrical installation 4.2 wide (Stage 4)
- (DK) Easement for underground powerlines 1 wide (stage 4)
- (EB) Easement to drain sewage 3 wide
- (ED) Easement for maintenance and repair 1 wide

NOTE:

Boundaries shown have been taken from an unregistered plan and final dimensions and areas are subject to the issue of the Subdivision Certificate and registration of the final plan of subdivision with the LRS. Final lot dimensions should be confirmed prior to the commencement of any works.

The finished surface levels and contours may vary to the design surface shown in this plan.

The location of utility services shown have been derived from design plans only. The existence of any proposed easements or covenants should also be confirmed.

Newton Denny Chapelle accepts no responsibility for any loss or damage suffered, however so arising, to any person or corporation who may use or rely on this plan.

This drawing is not to be reproduced without the inclusion of this disclaimer.

- KIP - Kerb Inlet Pit
- SMH - Sewer Manhole
- SJ - Sewer Connection
- SwP - Stormwater Pit
- IAD - Drainage Connection
- HC - House Connection - Water
- EPI - Electricity Pillar
- EPt - Electricity Pit
- LP - Light Pole
- NBN - Pit
- Site Boundary
- Easement
- Stormwater Drainage Line
- Sewer Line
- Water Main
- Retaining Wall
- Earthworks grading line



Property Details:
SUBDIVISION OF
LOT 400 of STAGE 4
EASTWOOD ESTATE

Newton Denny Chapelle
Surveyors Planners Engineers

Email: office@ndc.com.au
LISMORE (Head Office) 31 Carrington Street, Lismore NSW 2480
CASUARINA 18/56 Cylinders Drive, Kingscliff NSW 2487
PH: 02 6622 1011

LOT 501

CLIENT: McCLOY GROUP

LOCATION: Eastwood Estate
Invercauld road
Goonellabah

DATE: 18.08.21
SCALE: 1:400 @A4

REF: 18126-5-C
DRAWN: PS

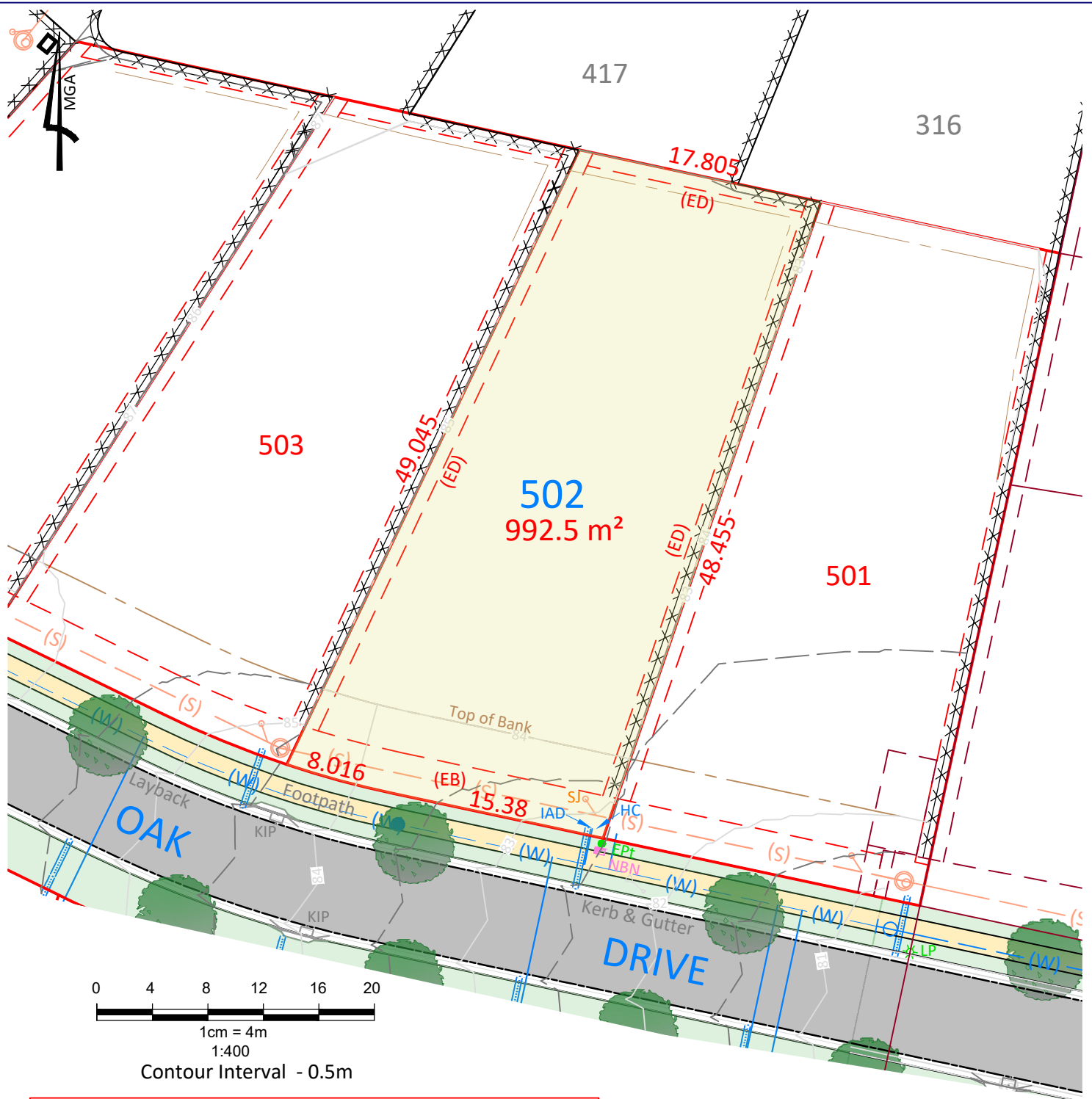

EASEMENTS

(EB) Easement to drain sewage 3 wide

(ED) Easement for maintenance and repair 1 wide)

NOTE:

Boundaries shown have been taken from an unregistered plan and final dimensions and areas are subject to the issue of the Subdivision Certificate and registration of the final plan of subdivision with the LRS. Final lot dimensions should be confirmed prior to the commencement of any works.

The finished surface levels and contours may vary to the design surface shown in this plan.

The location of utility services shown have been derived from design plans only. The existence of any proposed easements or covenants should also be confirmed. Newton Denny Chapelle accepts no responsibility for any loss or damage suffered, however so arising, to any person or corporation who may use or rely on this plan.

This drawing is not to be reproduced without the inclusion of this disclaimer.

	KIP - Kerb Inlet Pit
	SMH - Sewer Manhole
	SJ - Sewer Connection
	SwP - Stormwater Pit
	IAD - Drainage Connection
	HC - House Connection - Water
	EPI - Electricity Pillar
	EPt - Electricity Pit
	LP - Light Pole
	NBN - Pit
	Site Boundary
	Easement
	Stormwater Drainage Line
	Sewer Line
	Water Main
	Retaining Wall
	Earthworks grading line



Property Details:
SUBDIVISION OF
LOT 400 of STAGE 4
EASTWOOD ESTATE

Newton Denny Chapelle
Surveyors Planners Engineers

Email: office@ndc.com.au
LISMORE (Head Office) 31 Carrington Street, Lismore NSW 2480
CASUARINA 18/56 Cylinders Drive, Kingscliff NSW 2487
PH: 02 6622 1011

LOT 502

CLIENT: McCLOY GROUP

LOCATION: Eastwood Estate
Invercauld road
Goonellabah

DATE: 18.08.21
SCALE: 1:400 @A4

REF: 18126-5-C
DRAWN: PS

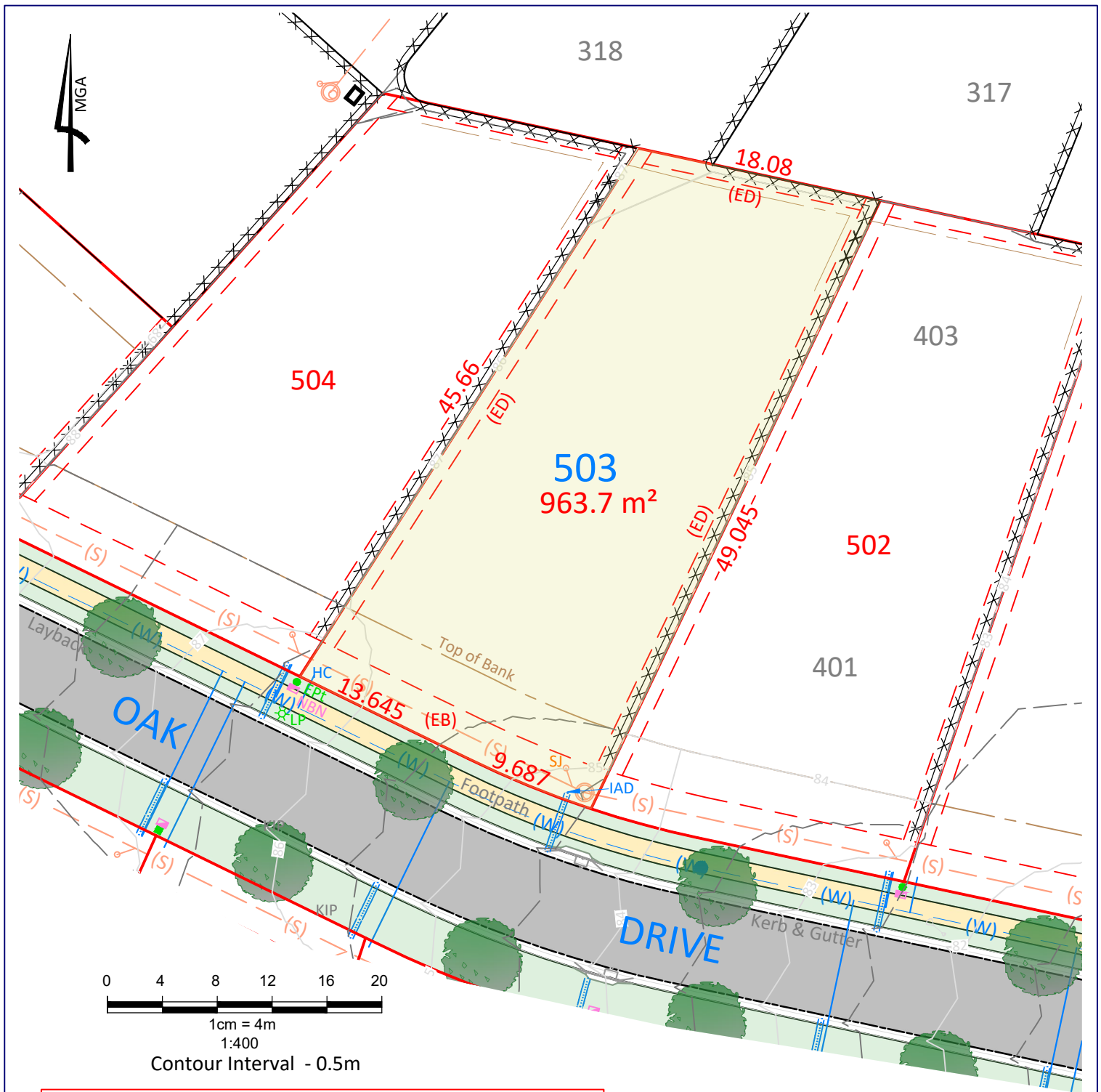

EASEMENTS

(EB) Easement to drain sewage 3 wide

(ED) Easement for maintenance and repair 1m wide

NOTE:

Boundaries shown have been taken from an unregistered plan and final dimensions and areas are subject to the issue of the Subdivision Certificate and registration of the final plan of subdivision with the LRS. Final lot dimensions should be confirmed prior to the commencement of any works.

The finished surface levels and contours may vary to the design surface shown in this plan.

The location of utility services shown have been derived from design plans only.

The existence of any proposed easements or covenants should also be confirmed. Newton Denny Chapelle accepts no responsibility for any loss or damage suffered, however so arising, to any person or corporation who may use or rely on this plan.

This drawing is not to be reproduced without the inclusion of this disclaimer.

- KIP - Kerb Inlet Pit
- SMH - Sewer Manhole
- SJ - Sewer Connection
- SwP - Stormwater Pit
- IAD - Drainage Connection
- HC - House Connection - Water
- EPI - Electricity Pillar
- EPt - Electricity Pit
- LP - Light Pole
- NBN - Pit
- Site Boundary
- Easement
- Stormwater Drainage Line
- Sewer Line
- Water Main
- Retaining Wall
- Earthworks grading line



Property Details:
**SUBDIVISION OF
LOT 400 of STAGE 4
EASTWOOD ESTATE**

Newton Denny Chapelle
Surveyors Planners Engineers

Email: office@ndc.com.au
LISMORE (Head Office) 31 Carrington Street, Lismore NSW 2480
CASUARINA 18/56 Cylinders Drive, Kingscliff NSW 2487
PH: 02 6622 1011

LOT 503

CLIENT: **McCLOY GROUP**

LOCATION: **Eastwood Estate
Invercauld road
Goonellabah**

DATE: **DATE 18.08.21**
SCALE: **1:400 @A4**

REF: **18126-5-C**
DRAWN: **PS**

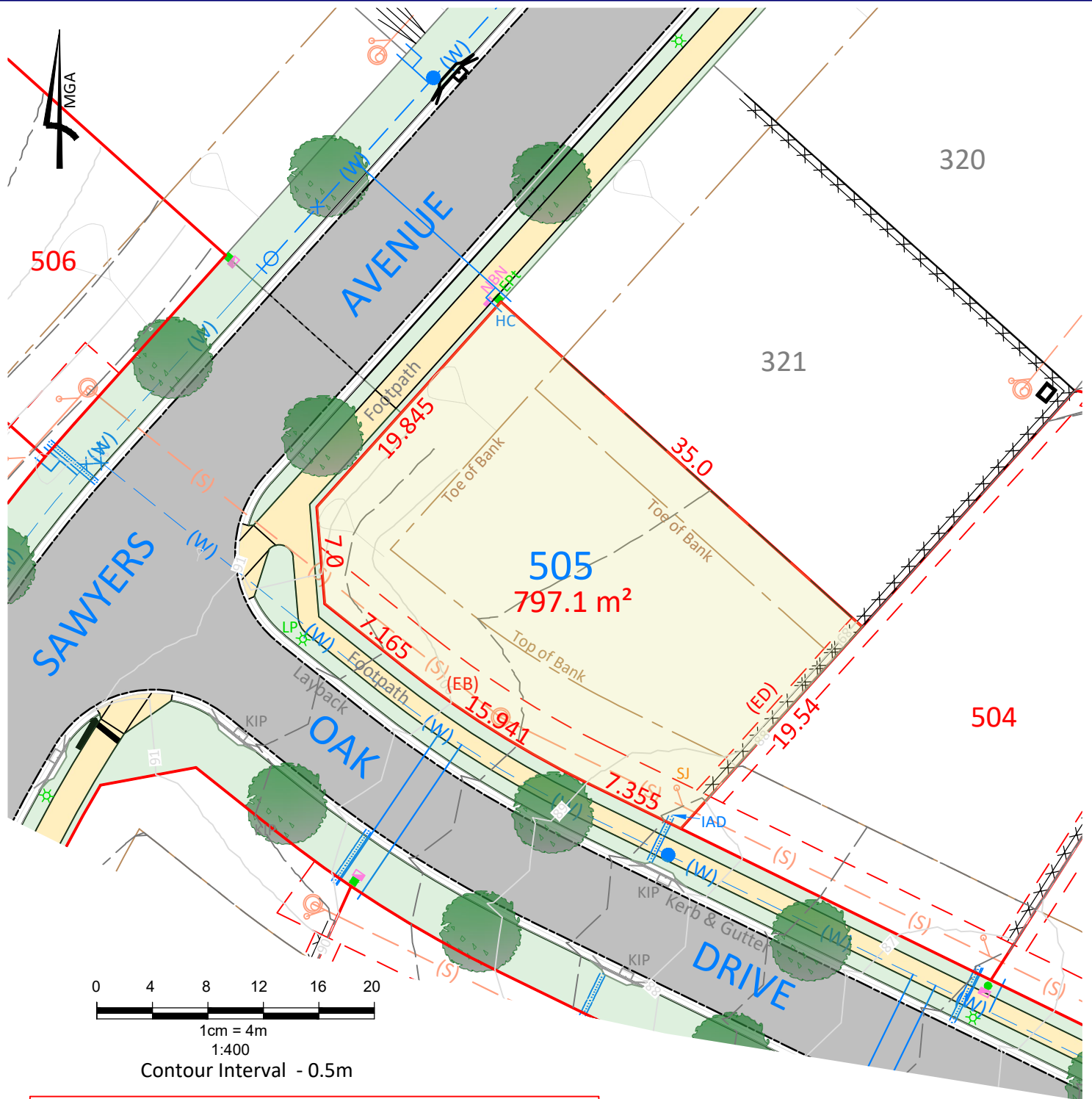

EASEMENTS

(EB) Easement to drain sewage 3 wide

(ED) Easement for maintenance and repair 1m wide

NOTE:

Boundaries shown have been taken from an unregistered plan and final dimensions and areas are subject to the issue of the Subdivision Certificate and registration of the final plan of subdivision with the LRS. Final lot dimensions should be confirmed prior to the commencement of any works.

The finished surface levels and contours may vary to the design surface shown in this plan.

The location of utility services shown have been derived from design plans only.

The existence of any proposed easements or covenants should also be confirmed. Newton Denny Chapelle accepts no responsibility for any loss or damage suffered, however so arising, to any person or corporation who may use or rely on this plan.

This drawing is not to be reproduced without the inclusion of this disclaimer.

	KIP - Kerb Inlet Pit
	SMH - Sewer Manhole
	SJ - Sewer Connection
	SwP - Stormwater Pit
	IAD - Drainage Connection
	HC - House Connection - Water
	EPI - Electricity Pillar
	EPT - Electricity Pit
	LP - Light Pole
	NBN - Pit
	Site Boundary
	Easement
	Stormwater Drainage Line
	Sewer Line
	Water Main
	Retaining Wall
	Earthworks grading line



Property Details:
SUBDIVISION OF
LOT 400 of STAGE 4
EASTWOOD ESTATE

Newton Denny Chapelle
Surveyors Planners Engineers
Email: office@ndc.com.au

LISMORE (Head Office) 31 Carrington Street, Lismore NSW 2480
CASUARINA 18/56 Cylinders Drive, Kingscliff NSW 2487
PH: 02 6622 1011

LOT 505

CLIENT: McCLOY GROUP

LOCATION: Eastwood Estate
Invercauld road
Goonellabah

DATE: 18.08.21
SCALE: 1:400 @A4

REF: 18126-5-C
DRAWN: PS

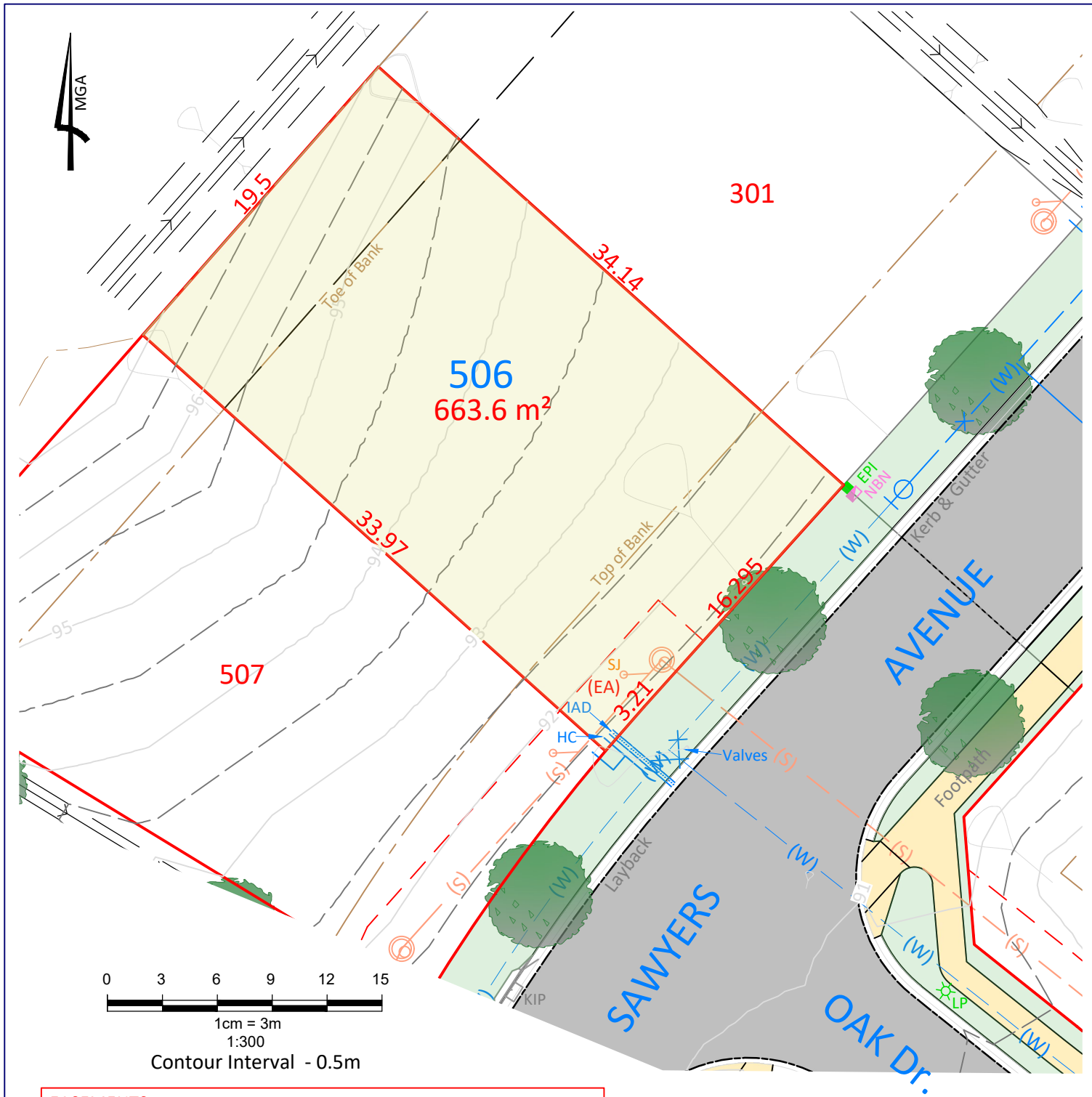

EASEMENTS

(EA) Easement to drain sewage - variable width

NOTE:

Boundaries shown have been taken from an unregistered plan and final dimensions and areas are subject to the issue of the Subdivision Certificate and registration of the final plan of subdivision with the LRS. Final lot dimensions should be confirmed prior to the commencement of any works.

The finished surface levels and contours may vary to the design surface shown in this plan.

The location of utility services shown have been derived from design plans only. The existence of any proposed easements or covenants should also be confirmed. Newton Denny Chapelle accepts no responsibility for any loss or damage suffered, however so arising, to any person or corporation who may use or rely on this plan.

This drawing is not to be reproduced without the inclusion of this disclaimer.

	KIP - Kerb Inlet Pit
	SMH - Sewer Manhole
	SJ - Sewer Connection
	SwP - Stormwater Pit
	IAD - Drainage Connection
	HC - House Connection - Water
	EPI - Electricity Pillar
	EPT - Electricity Pit
	LP - Light Pole
	NBN - Pit
	Site Boundary
	Easement
	Stormwater Drainage Line
	Sewer Line
	Water Main
	Retaining Wall
	Earthworks grading line



Property Details:
SUBDIVISION OF
LOT 400 of STAGE 4
EASTWOOD ESTATE

Newton Denny Chapelle
Surveyors Planners Engineers
Email: office@ndc.com.au

LISMORE (Head Office) 31 Carrington Street, Lismore NSW 2480
CASUARINA 18/56 Cylinders Drive, Kingscliff NSW 2487
PH: 02 6622 1011

LOT 506

CLIENT: McCLOY GROUP

LOCATION: Eastwood Estate
Invercauld road
Goonellabah

DATE: 18.08.21
SCALE: 1:300 @A4

REF: 18126-5-C
DRAWN: PS

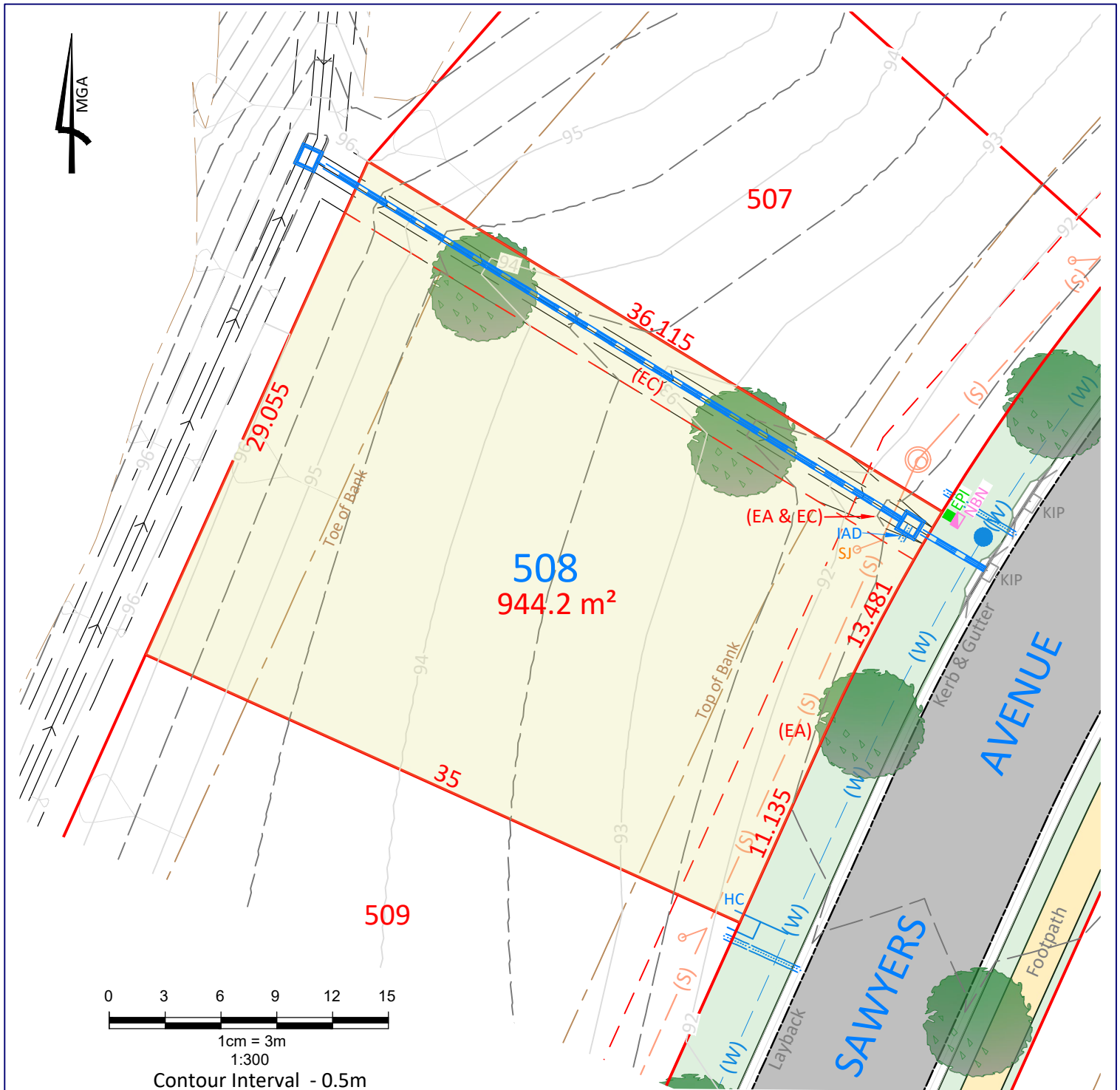

EASEMENTS

- (EA) Easement to drain sewage - variable width
(EC) Easement to drain water 3 wide

NOTE:

Boundaries shown have been taken from an unregistered plan and final dimensions and areas are subject to the issue of the Subdivision Certificate and registration of the final plan of subdivision with the LRS. Final lot dimensions should be confirmed prior to the commencement of any works.
The finished surface levels and contours may vary to the design surface shown in this plan.
The location of utility services shown have been derived from design plans only. The existence of any proposed easements or covenants should also be confirmed.
Newton Denny Chapelle accepts no responsibility for any loss or damage suffered, however so arising, to any person or corporation who may use or rely on this plan.
This drawing is not to be reproduced without the inclusion of this disclaimer.

- KIP - Kerb Inlet Pit
- SMH - Sewer Manhole
- SJ - Sewer Connection
- SwP - Stormwater Pit
- IAD - Drainage Connection
- HC - House Connection - Water
- EPI - Electricity Pillar
- EPT - Electricity Pit
- LP - Light Pole
- NBN - Pit
- Site Boundary
- Easement
- Stormwater Drainage Line
- Sewer Line
- Water Main
- Retaining Wall
- Earthworks grading line



Property Details:
**SUBDIVISION OF
LOT 400 of STAGE 4
EASTWOOD ESTATE**

Newton Denny Chapelle
Surveyors Planners Engineers
Email: office@ndc.com.au

LISMORE (Head Office) 31 Carrington Street, Lismore NSW 2480
CASUARINA 18/56 Cylinders Drive, Kingscliff NSW 2487
PH: 02 6622 1011

LOT 508

CLIENT: **McCLOY GROUP**

LOCATION: **Eastwood Estate
Invercauld road
Goonellabah**

DATE: **18.08.21**
SCALE: **1:300 @A4**

REF: **18126-5-C**
DRAWN: **PS**

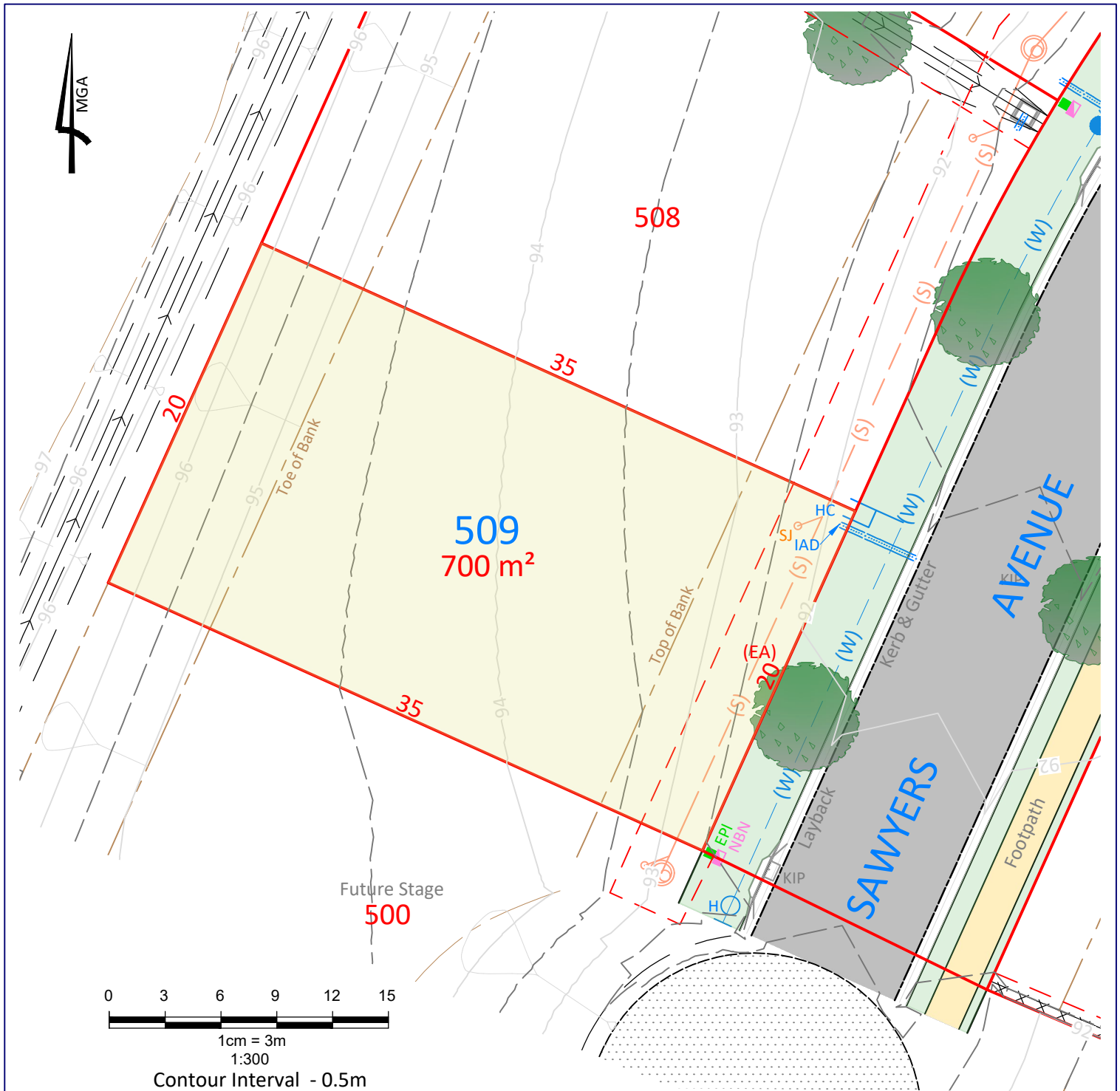

EASEMENTS

(EA) Easement to drain sewage - variable width

NOTE:

Boundaries shown have been taken from an unregistered plan and final dimensions and areas are subject to the issue of the Subdivision Certificate and registration of the final plan of subdivision with the LRS. Final lot dimensions should be confirmed prior to the commencement of any works.

The finished surface levels and contours may vary to the design surface shown in this plan.

The location of utility services shown have been derived from design plans only. The existence of any proposed easements or covenants should also be confirmed.

Newton Denny Chapelle accepts no responsibility for any loss or damage suffered, however so arising, to any person or corporation who may use or rely on this plan.

This drawing is not to be reproduced without the inclusion of this disclaimer.

	KIP - Kerb Inlet Pit
	SMH - Sewer Manhole
	SJ - Sewer Connection
	SwP - Stormwater Pit
	IAD - Drainage Connection
	HC - House Connection - Water
	EPI - Electricity Pillar
	EPt - Electricity Pit
	LP - Light Pole
	NBN - Pit
	Site Boundary
	Easement
	Stormwater Drainage Line
	Sewer Line
	Water Main
	Retaining Wall
	Earthworks grading line

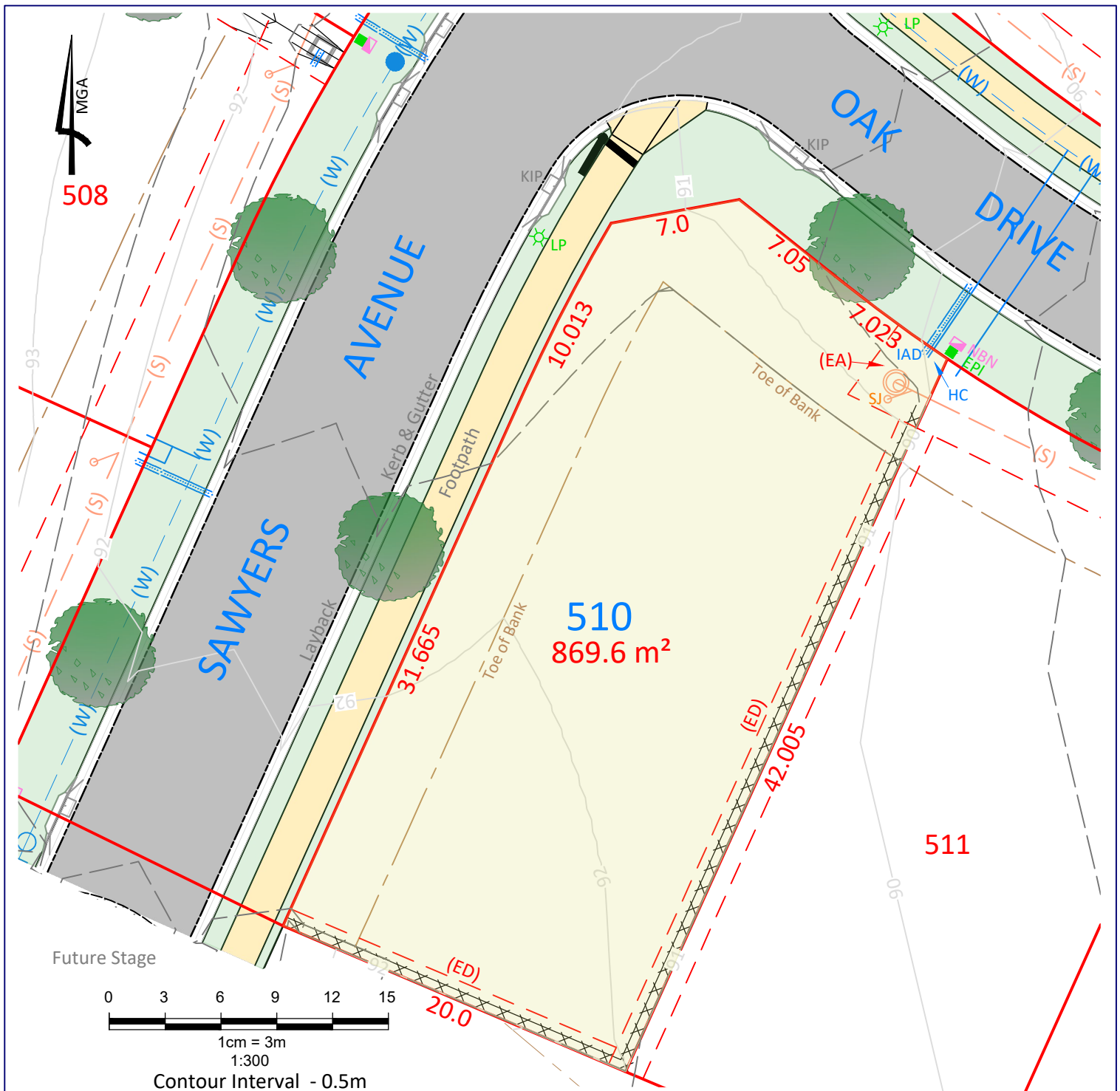

EASEMENTS

- (EA) Easement to drain sewage - variable width
(ED) Easement for maintenance and repair 1m wide

NOTE:

Boundaries shown have been taken from an unregistered plan and final dimensions and areas are subject to the issue of the Subdivision Certificate and registration of the final plan of subdivision with the LRS. Final lot dimensions should be confirmed prior to the commencement of any works.

The finished surface levels and contours may vary to the design surface shown in this plan.

The location of utility services shown have been derived from design plans only. The existence of any proposed easements or covenants should also be confirmed.

Newton Denny Chapelle accepts no responsibility for any loss or damage suffered, however so arising, to any person or corporation who may use or rely on this plan.

This drawing is not to be reproduced without the inclusion of this disclaimer.

- KIP - Kerb Inlet Pit
- SMH - Sewer Manhole
- SJ - Sewer Connection
- SwP - Stormwater Pit
- IAD - Drainage Connection
- HC - House Connection - Water
- EPI - Electricity Pillar
- EPt - Electricity Pit
- LP - Light Pole
- NBN - Pit
- Site Boundary
- Easement
- Stormwater Drainage Line
- Sewer Line
- Water Main
- Retaining Wall
- Earthworks grading line



Property Details:
**SUBDIVISION OF
LOT 400 of STAGE 4
EASTWOOD ESTATE**

Newton Denny Chapelle
Surveyors Planners Engineers

Email: office@ndc.com.au
LISMORE (Head Office) 31 Carrington Street, Lismore NSW 2480
CASUARINA 18/56 Cylinders Drive, Kingscliff NSW 2487
PH: 02 6622 1011

LOT 510

CLIENT: **McCLOY GROUP**

LOCATION: **Eastwood Estate
Invercauld road
Goonellabah**

DATE: **DATE 18.08.21**
SCALE: **1:300 @A4**

REF: **18126-5-C**
DRAWN: **PS**

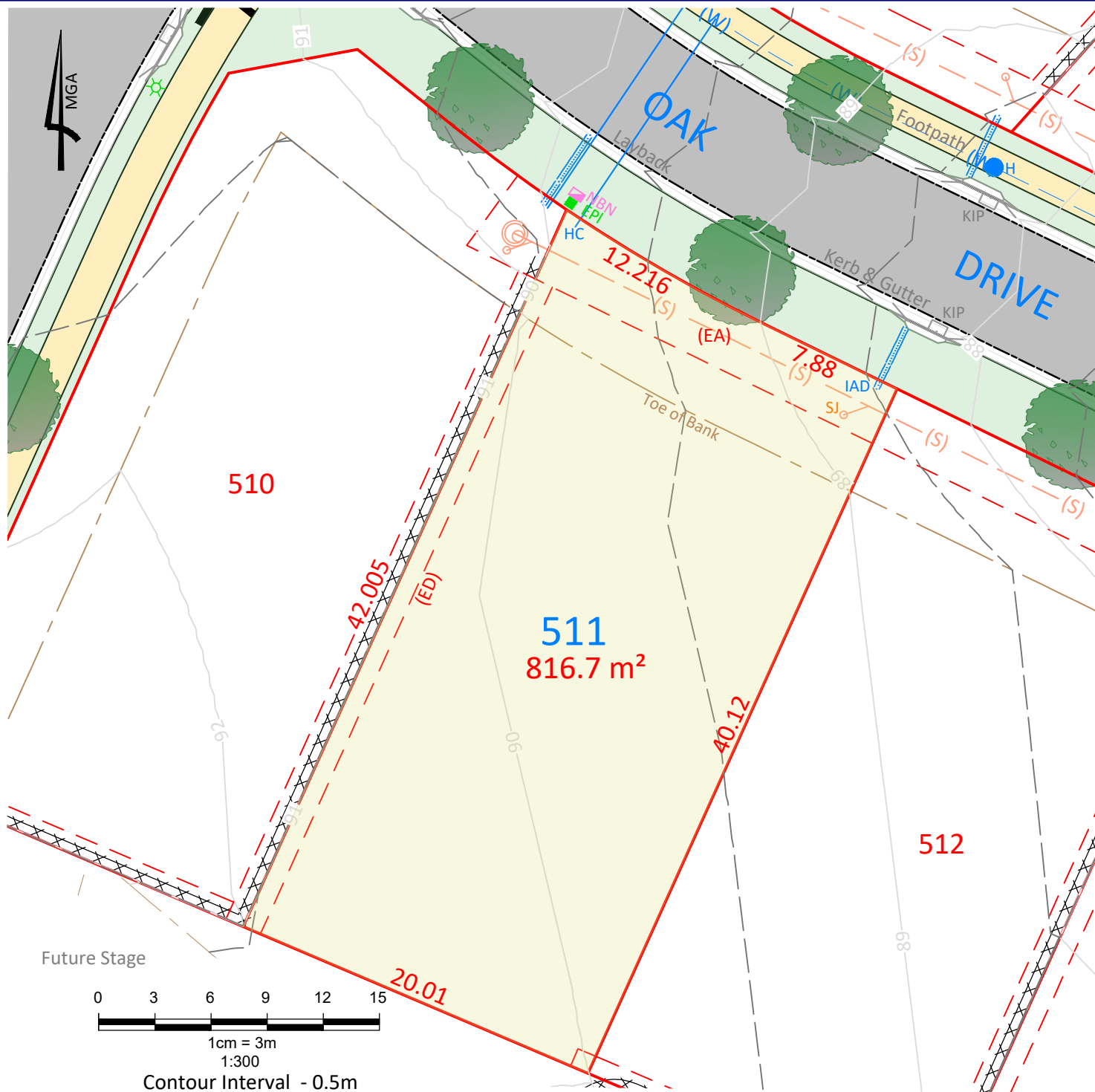

Property Details:
**SUBDIVISION OF
LOT 400 of STAGE 4
EASTWOOD ESTATE**

Newton Denny Chapelle
Surveyors Planners Engineers
Email: office@ndc.com.au

LISMORE (Head Office) 31 Carrington Street, Lismore NSW 2480
CASUARINA 18/56 Cylinders Drive, Kingscliff NSW 2487
PH: 02 6622 1011

LOT 511

CLIENT: **McCLOY GROUP**

LOCATION: **Eastwood Estate
Invercauld road
Goonellabah**

DATE: **18.08.21**
SCALE: **1:300 @A4**

REF: **18126-5-C**
DRAWN: **PS**

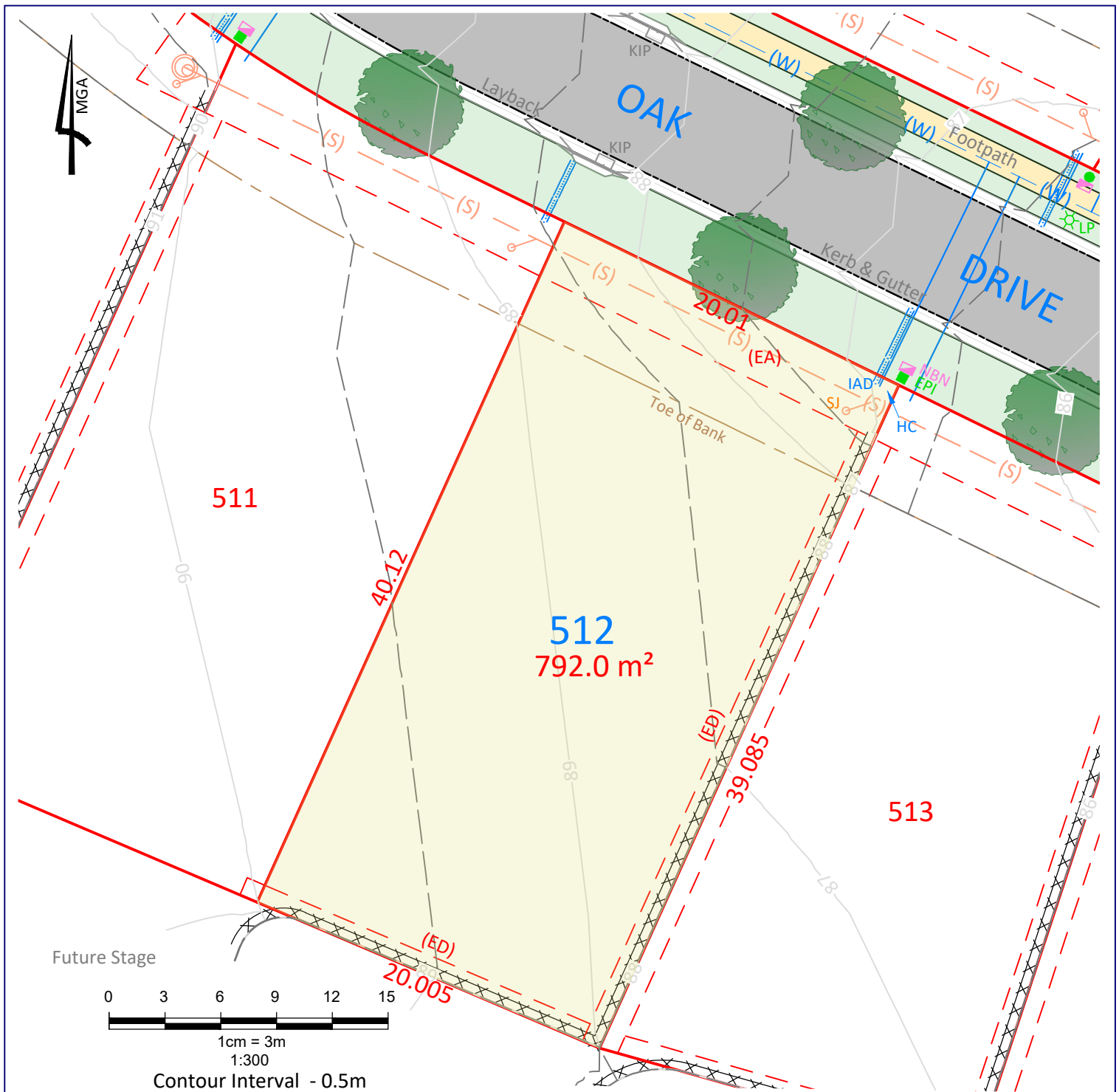

EASEMENTS

- (EA) Easement to drain sewage - variable width
(ED) Easement for maintenance and repair 1m wide

NOTE:

Boundaries shown have been taken from an unregistered plan and final dimensions and areas are subject to the issue of the Subdivision Certificate and registration of the final plan of subdivision with the LRS. Final lot dimensions should be confirmed prior to the commencement of any works.
The finished surface levels and contours may vary to the design surface shown in this plan.
The location of utility services shown have been derived from design plans only. The existence of any proposed easements or covenants should also be confirmed.
Newton Denny Chapelle accepts no responsibility for any loss or damage suffered, however so arising, to any person or corporation who may use or rely on this plan.
This drawing is not to be reproduced without the inclusion of this disclaimer.

- KIP - Kerb Inlet Pit
- SMH - Sewer Manhole
- SJ - Sewer Connection
- SwP - Stormwater Pit
- IAD - Drainage Connection
- HC - House Connection - Water
- EPI - Electricity Pillar
- EPT - Electricity Pit
- LP - Light Pole
- NBN - Pit
- Site Boundary
- Easement
- Stormwater Drainage Line
- Sewer Line
- Water Main
- Retaining Wall
- Earthworks grading line



Property Details:
SUBDIVISION OF
LOT 400 of STAGE 4
EASTWOOD ESTATE

Newton Denny Chapelle
Surveyors Planners Engineers
Email: office@ndc.com.au

LISMORE (Head Office) 31 Carrington Street, Lismore NSW 2480
CASUARINA 18/56 Cylinders Drive, Kingscliff NSW 2487
PH: 02 6622 1011

LOT 512

CLIENT: McCLOY GROUP

LOCATION: Eastwood Estate
Invercauld road
Goonellabah

DATE: 18.08.21
SCALE: 1:300 @A4

REF: 18126-5-C
DRAWN: PS

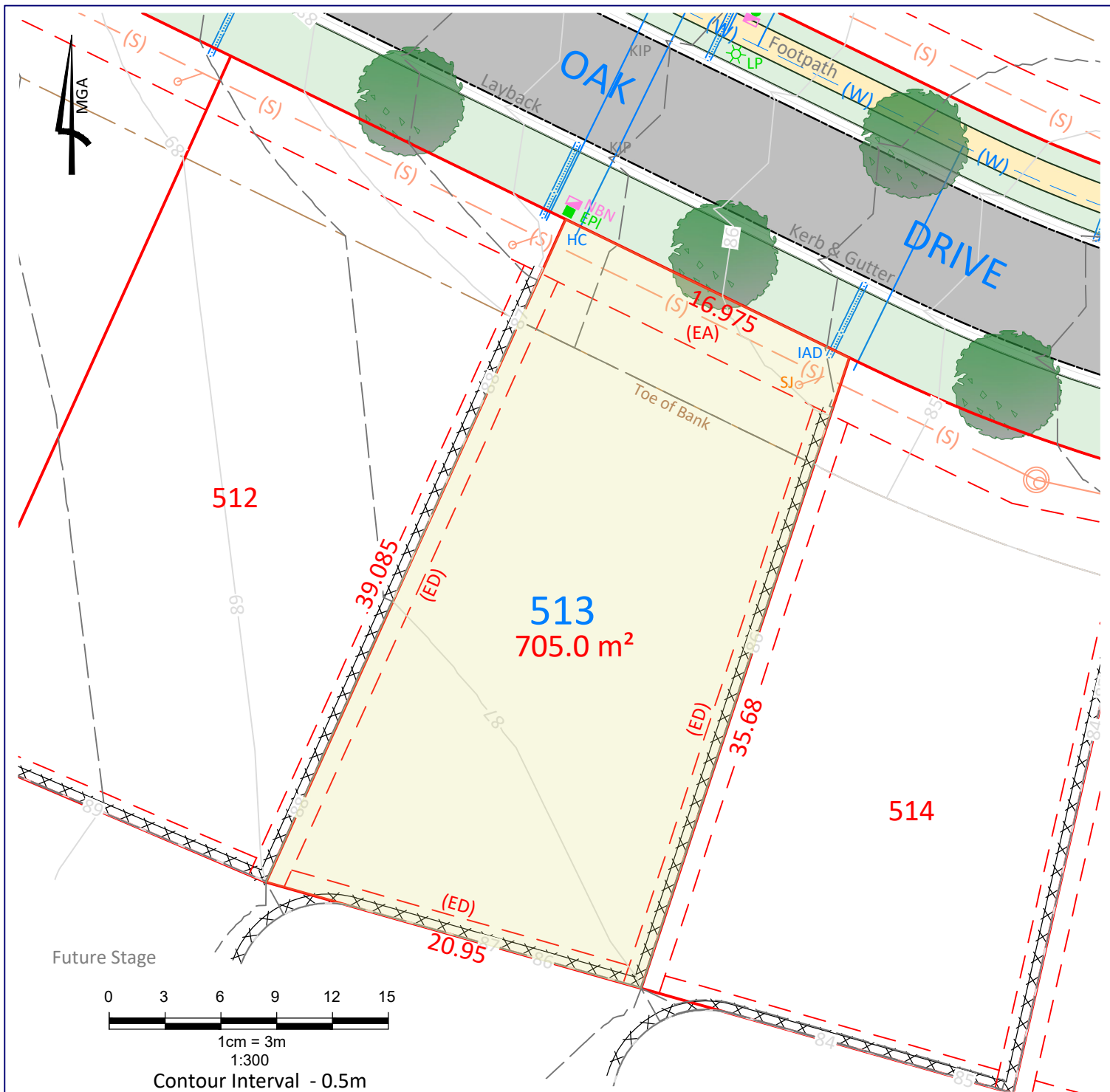

EASEMENTS

- (EA) Easement to drain sewage - variable width
(ED) Easement for maintenance and repair 1m wide

NOTE:

Boundaries shown have been taken from an unregistered plan and final dimensions and areas are subject to the issue of the Subdivision Certificate and registration of the final plan of subdivision with the LRS. Final lot dimensions should be confirmed prior to the commencement of any works.
The finished surface levels and contours may vary to the design surface shown in this plan.
The location of utility services shown have been derived from design plans only. The existence of any proposed easements or covenants should also be confirmed.
Newton Denny Chapelle accepts no responsibility for any loss or damage suffered, however so arising, to any person or corporation who may use or rely on this plan.
This drawing is not to be reproduced without the inclusion of this disclaimer.

- KIP - Kerb Inlet Pit
- SMH - Sewer Manhole
- SJ - Sewer Connection
- SwP - Stormwater Pit
- IAD - Drainage Connection
- HC - House Connection - Water
- EPI - Electricity Pillar
- EPT - Electricity Pit
- LP - Light Pole
- NBN - Pit
- Site Boundary
- Easement
- Stormwater Drainage Line
- Sewer Line
- Water Main
- Retaining Wall
- Earthworks grading line



Property Details:
SUBDIVISION OF
LOT 400 of STAGE 4
EASTWOOD ESTATE

Newton Denny Chapelle
Surveyors Planners Engineers
Email: office@ndc.com.au

LISMORE (Head Office) 31 Carrington Street, Lismore NSW 2480
CASUARINA 18/56 Cylinders Drive, Kingscliff NSW 2487
PH: 02 6622 1011

LOT 513

CLIENT: McCLOY GROUP

LOCATION: Eastwood Estate
Invercauld road
Goonellabah

DATE: 18.08.21
SCALE: 1:300 @A4

REF: 18126-5-C
DRAWN: PS

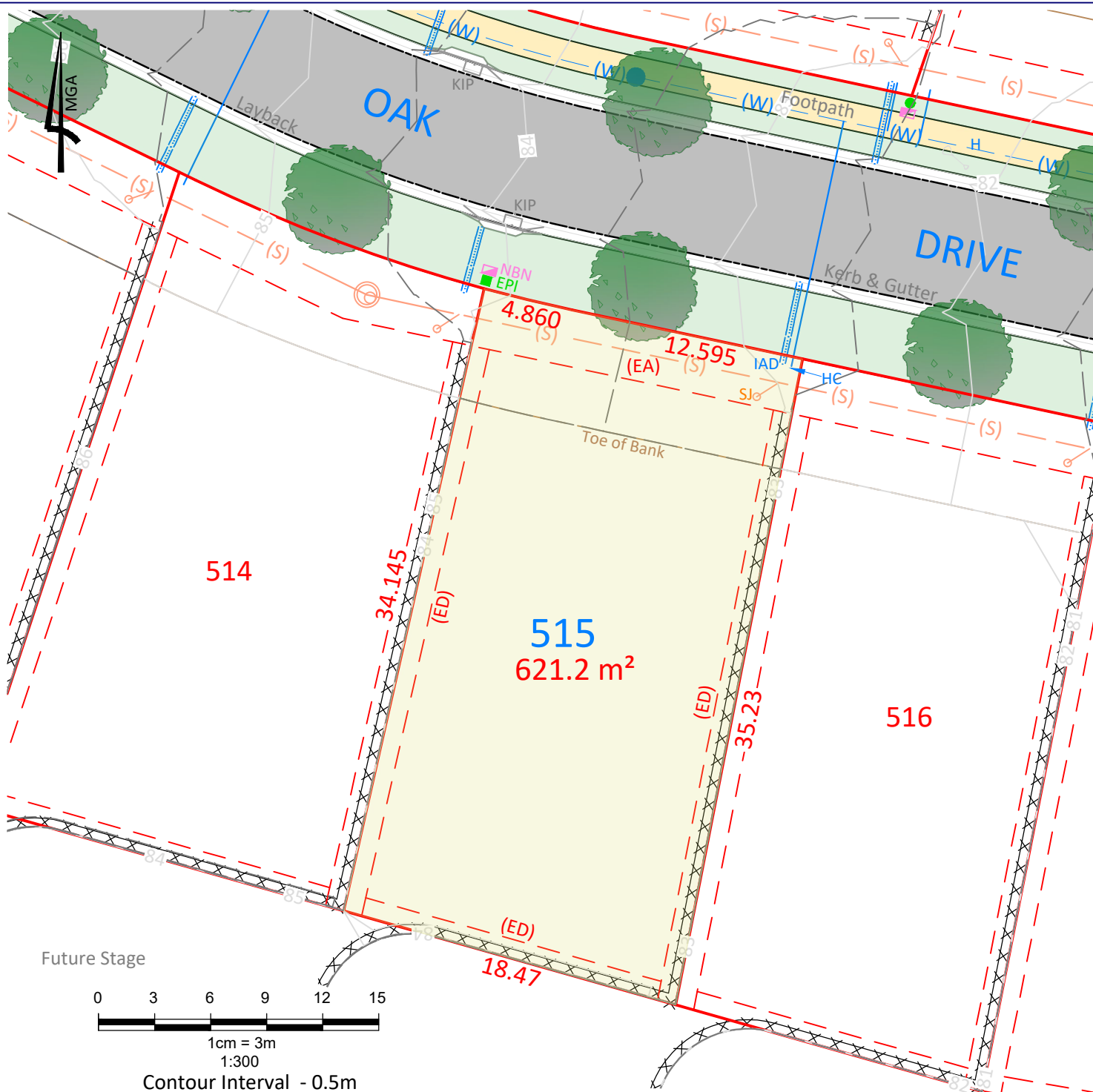

EASEMENTS

- (EA) Easement to drain sewage - variable width
- (ED) Easement for maintenance and repair 1m wide

NOTE:

Boundaries shown have been taken from an unregistered plan and final dimensions and areas are subject to the issue of the Subdivision Certificate and registration of the final plan of subdivision with the LRS. Final lot dimensions should be confirmed prior to the commencement of any works.

The finished surface levels and contours may vary to the design surface shown in this plan.

The location of utility services shown have been derived from design plans only. The existence of any proposed easements or covenants should also be confirmed.

Newton Denny Chapelle accepts no responsibility for any loss or damage suffered, however so arising, to any person or corporation who may use or rely on this plan.

This drawing is not to be reproduced without the inclusion of this disclaimer.

- KIP - Kerb Inlet Pit
- SMH - Sewer Manhole
- SJ - Sewer Connection
- SwP - Stormwater Pit
- IAD - Drainage Connection
- HC - House Connection - Water
- EPI - Electricity Pillar
- EPT - Electricity Pit
- LP - Light Pole
- NBN - Pit
- Site Boundary
- Easement
- Stormwater Drainage Line
- Sewer Line
- Water Main
- Retaining Wall
- Earthworks grading line



Property Details:
SUBDIVISION OF
LOT 400 of STAGE 4
EASTWOOD ESTATE

Newton Denny Chapelle
Surveyors Planners Engineers
Email: office@ndc.com.au

LISMORE (Head Office) 31 Carrington Street, Lismore NSW 2480
CASUARINA 18/56 Cylinders Drive, Kingscliff NSW 2487
PH: 02 6622 1011

LOT 515

CLIENT: McCLOY GROUP

LOCATION: Eastwood Estate
Invercauld road
Goonellabah

DATE: 18.08.21
SCALE: 1:300 @A4

REF: 18126-5-C
DRAWN: PS

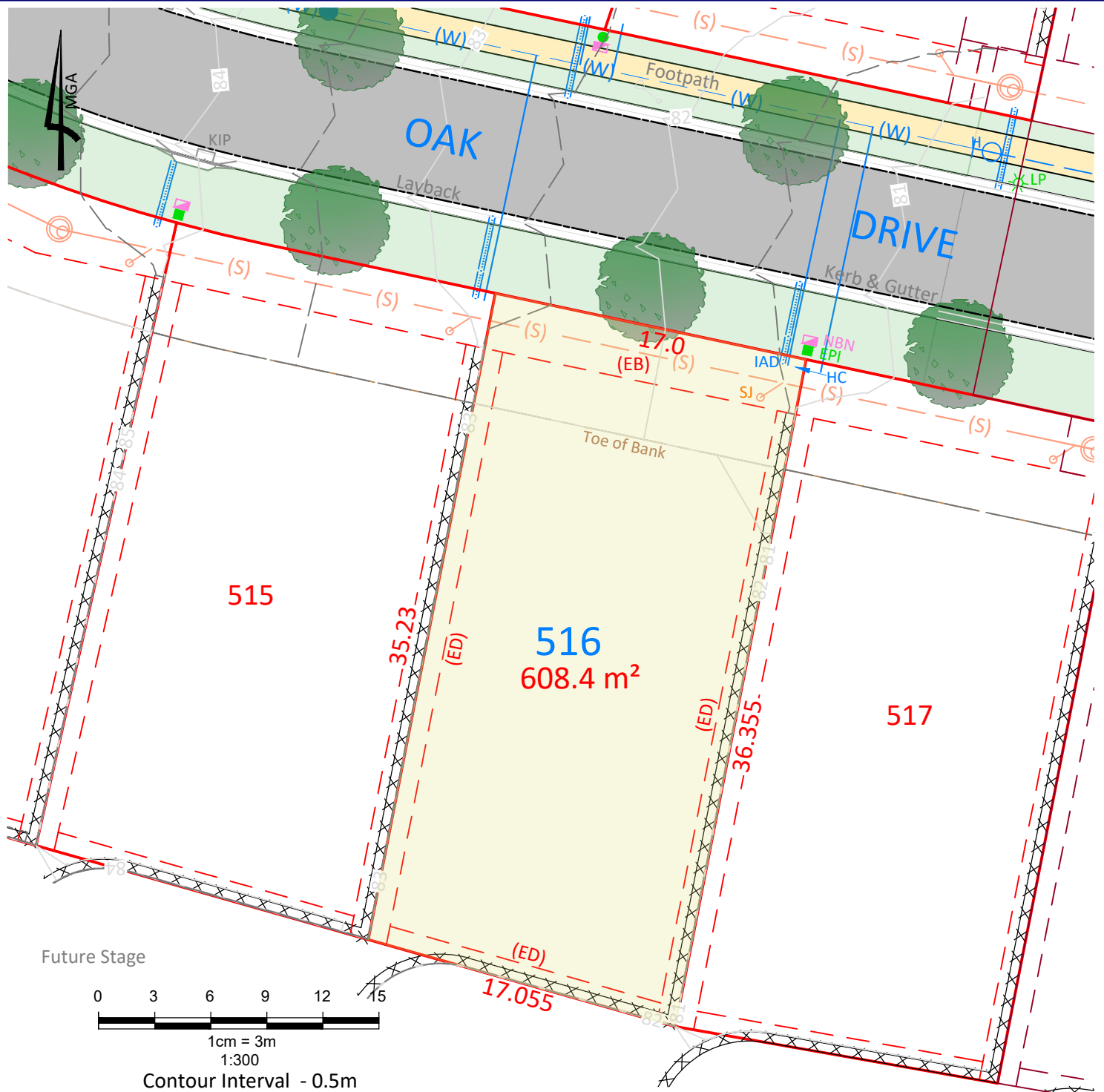

EASEMENTS

(EB) Easement to drain sewage 3 wide

(ED) Easement for maintenance and repair 1m wide

NOTE:

Boundaries shown have been taken from an unregistered plan and final dimensions and areas are subject to the issue of the Subdivision Certificate and registration of the final plan of subdivision with the LRS. Final lot dimensions should be confirmed prior to the commencement of any works.

The finished surface levels and contours may vary to the design surface shown in this plan.

The location of utility services shown have been derived from design plans only. The existence of any proposed easements or covenants should also be confirmed.

Newton Denny Chapelle accepts no responsibility for any loss or damage suffered, however so arising, to any person or corporation who may use or rely on this plan.

This drawing is not to be reproduced without the inclusion of this disclaimer.

	KIP - Kerb Inlet Pit
	SMH - Sewer Manhole
	SJ - Sewer Connection
	SwP - Stormwater Pit
	IAD - Drainage Connection
	HC - House Connection - Water
	EPI - Electricity Pillar
	EPT - Electricity Pit
	LP - Light Pole
	NBN - Pit
	Site Boundary
	Easement
	Stormwater Drainage Line
	Sewer Line
	Water Main
	Retaining Wall
	Earthworks grading line



Property Details:
SUBDIVISION OF
LOT 400 of STAGE 4
EASTWOOD ESTATE

Newton Denny Chapelle
Surveyors Planners Engineers
Email: office@ndc.com.au

LISMORE (Head Office) 31 Carrington Street, Lismore NSW 2480
CASUARINA 18/56 Cylinders Drive, Kingscliff NSW 2487
PH: 02 6622 1011

LOT 516

CLIENT: McCLOY GROUP

LOCATION: Eastwood Estate
Invercauld road
Goonellabah

DATE: 18.08.21
SCALE: 1:300 @A4

REF: 18126-5-C
DRAWN: PS

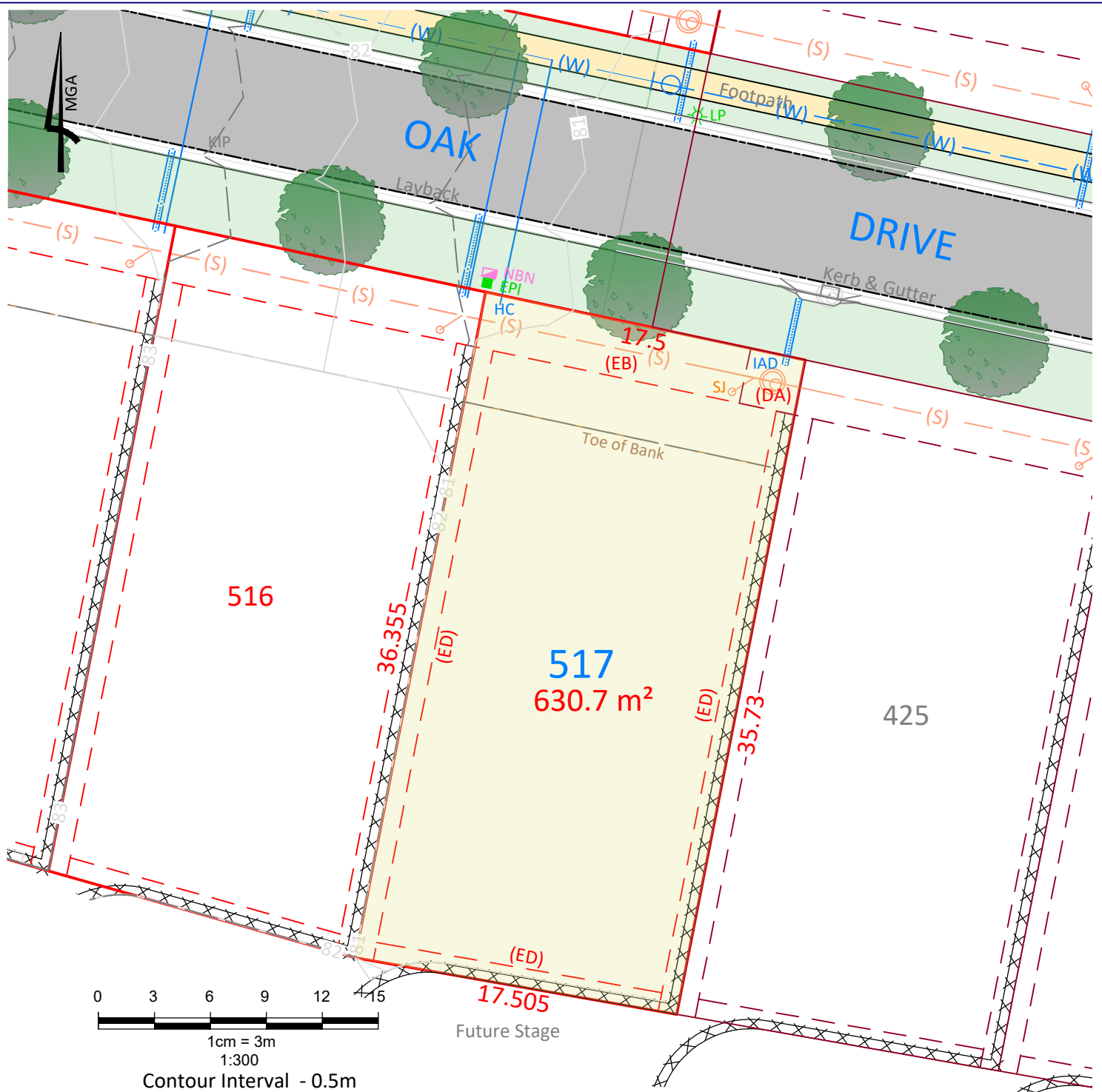

EASEMENTS

- (DA) Easement to drain sewage - variable width (Stage 4)
- (EB) Easement to drain sewage 3 wide
- (ED) Easement for maintenance and repair 1m wide

NOTE:

Boundaries shown have been taken from an unregistered plan and final dimensions and areas are subject to the issue of the Subdivision Certificate and registration of the final plan of subdivision with the LRS. Final lot dimensions should be confirmed prior to the commencement of any works.

The finished surface levels and contours may vary to the design surface shown in this plan.

The location of utility services shown have been derived from design plans only. The existence of any proposed easements or covenants should also be confirmed.

Newton Denny Chapelle accepts no responsibility for any loss or damage suffered, however so arising, to any person or corporation who may use or rely on this plan.

This drawing is not to be reproduced without the inclusion of this disclaimer.

- KIP - Kerb Inlet Pit
- SMH - Sewer Manhole
- SJ - Sewer Connection
- SwP - Stormwater Pit
- IAD - Drainage Connection
- HC - House Connection - Water
- EPI - Electricity Pillar
- EPT - Electricity Pit
- LP - Light Pole
- NBN - Pit
- Site Boundary
- Easement
- Stormwater Drainage Line
- Sewer Line
- Water Main
- Retaining Wall
- Earthworks grading line



Property Details:
SUBDIVISION OF
LOT 400 of STAGE 4
EASTWOOD ESTATE

Newton Denny Chapelle
Surveyors Planners Engineers

Email: office@ndc.com.au
LISMORE (Head Office) 31 Carrington Street, Lismore NSW 2480
CASUARINA 18/56 Cylinders Drive, Kingscliff NSW 2487
PH: 02 6622 1011

LOT 517

CLIENT: McCLOY GROUP

LOCATION: Eastwood Estate
Invercauld road
Goonellabah

DATE: 18.08.21
SCALE: 1:300 @A4

REF: 18126-5-C
DRAWN: PS